



Floorplans



Music City Center Floorplans

Table of Contents

- 1 Stacked Map
- 2 **Level 1:** Meeting Rooms
- 4 **Level 1M:** Davidson Ballroom
- 5 **Level 2:** Meeting Rooms
- 7 **Level 3:** Exhibit Hall
- 8 **Level 3M:** Show Managers
- 9 **Level 4:** Karl F. Dean Grand Ballroom
- 10 Food & Beverage
- 11 Sustainability

Quick Facts

Meeting rooms: 61

Davidson Ballroom:
17,900 sq. ft.
Ceiling Height 20'

Exhibit Hall:
353,143 sq. ft.
Subdivided into 4 halls
(Hall A subdivided into 2 parts)
32'6" Rigging Height

Karl F. Dean Grand Ballroom:
57,500 sq. ft.
Stage: 78'W x 30'D
Stage Opening: 58'
Ceiling Height: 40'

Terraces:
Level 1: 19,000 sq. ft.
Level 3: 9,200 sq. ft.

NOTE:
Music City Center will implement best practices to prepare for, respond to and recover from outbreaks and pandemics as a GBAC STAR™ facility.

LEVEL 4

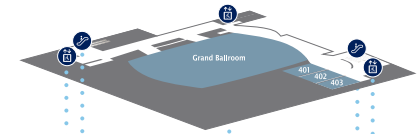

LEVEL 3

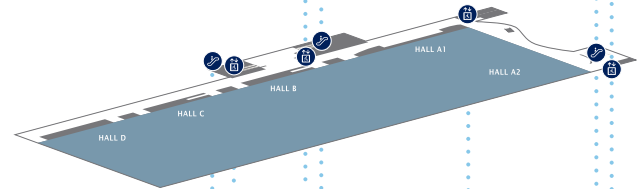

LEVEL 2

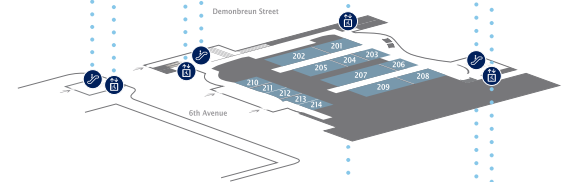

LEVEL 1M

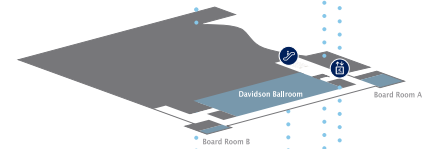

LEVEL 1

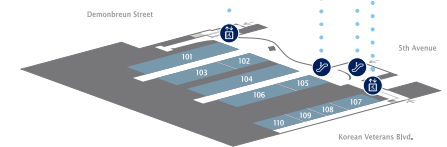

Level 1: Meeting Rooms



Meeting Rooms	Total Sq. Ft.	Theater	Classroom 18" X 96" Tables	Banquet 66" Rounds	Ceiling Height Footage	Dimensions
101 A	1550	182	108	120	18'	28'W x 52'D
101 B	1650	182	108	120	18'	30'W x 52'D
101 C	1650	182	108	120	18'	30'W x 52'D
101 D	1650	182	108	120	18'	30'W x 52'D
101 E	1550	182	108	120	18'	28'W x 52'D
101 A-E	8050	988	480	680	18'	146'W x 52'D
102 A	1600	196	108	120	18'	28'W x 52'D
102 B	1650	196	108	120	18'	29'W x 52'D
102 A-B	3250	396	180	290	18'	57'W x 52'D
103 A	1650	182	108	120	18'	29'W x 52'D
103 B	1700	196	108	120	18'	30'W x 52'D
103 C	1600	182	108	120	18'	28'W x 52'D
103 A-C	4950	582	180	400	18'	87'W x 52'D
104 A	1600	182	108	120	18'	28'W x 52'D
104 B	1700	182	108	120	18'	30'W x 52'D
104 C	1700	182	108	120	18'	30'W x 52'D
104 D	1700	182	108	120	18'	30'W x 52'D
104 E	1600	182	108	120	18'	28'W x 52'D
104 A-E	8300	1066	600	680	18'	146'W x 52'D
105 A	1600	182	108	100	18'	28'W x 52'D
105 B	1700	182	108	100	18'	29'W x 52'D
105 A-B	3300	396	180	270	18'	57'W x 52'D
106 A	1700	196	108	120	18'	30'W x 52'D
106 B	1700	196	108	120	18'	30'W x 52'D
106 C	1600	182	108	120	18'	28'W x 52'D
106 A-C	5000	582	252	400	18'	87'W x 52'D
107 A	1550	182	108	100	15'	28'W x 52'D
107 B	1550	182	108	100	15'	28'W x 52'D
107 A-B	3100	396	180	250	15'	56'W x 52'D
108	1400	182	64	100	15'	26'W x 52'D
109	1400	182	64	100	15'	26'W x 52'D
110 A	1550	196	108	100	15'	28'W x 52'D
110 B	1550	196	108	100	15'	28'W x 52'D
110 A-B	3100	396	180	250	15'	56'W x 52'D
Total	41,850	5166	2360	3420		
Prefunction	24,300					
Terrace	19,000					

Level 1: Meeting Rooms



Level 1M: Davidson Ballroom



Level 1M: Davidson Ballroom

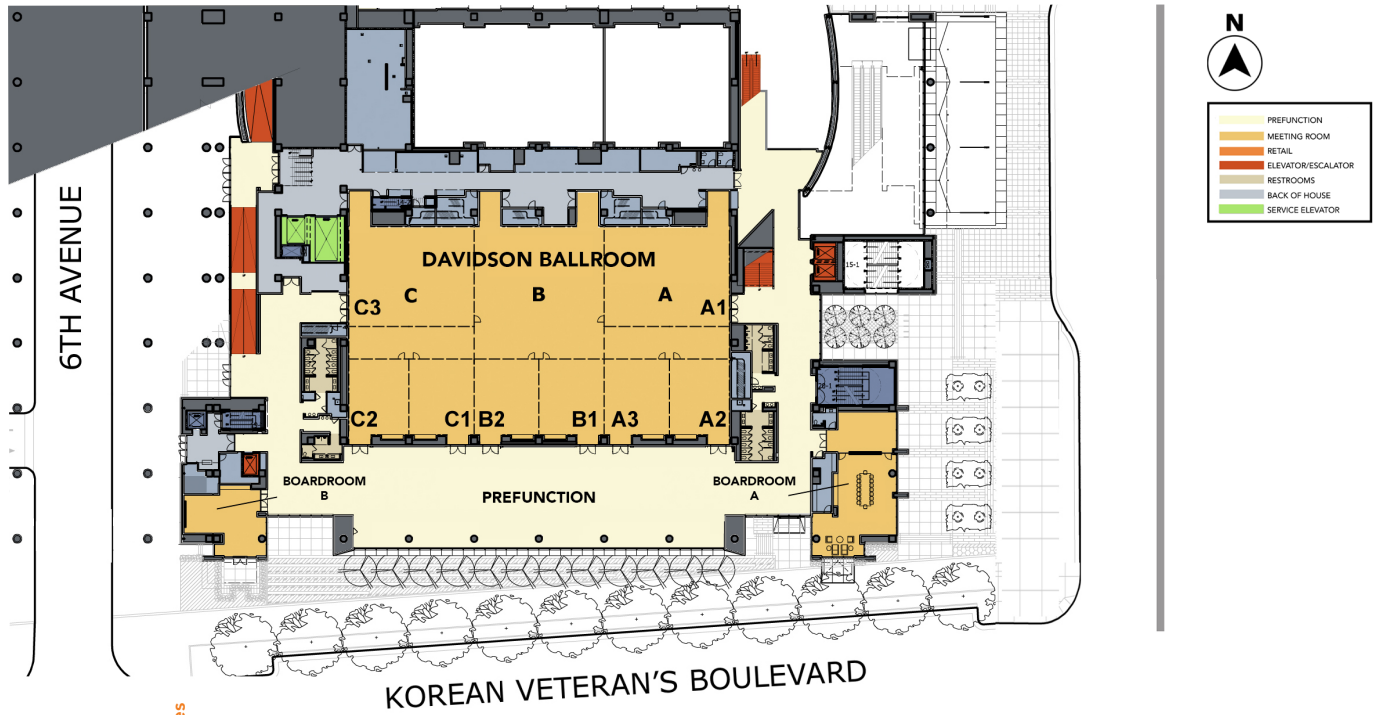

Ballrooms	Total Sq. Ft.	Theater	Classroom 18" X 96" Tables	Banquet 66" Rounds	Ceiling Height Footage	Dimensions
Davidson A	5850	800	360	450	20'	57'W x 96'D
A1	2800	392	180	230	20'	46'W x 57'D
A2	1000	112	60	80	20'	30'W x 35'D
A3	1100	122	60	80	20'	27'W x 35'D
Davidson B	6200	800	360	450	20'	60'W x 96'D
B1	1100	122	60	80	20'	30'W x 35'D
B2	1100	122	60	80	20'	30'W x 35'D
Davidson C	5850	800	360	450	20'	57'W x 96'D
C1	1100	122	60	80	20'	30'W x 35'D
C2	1000	112	60	80	20'	27'W x 35'D
C3	2800	392	180	230	20'	46'W x 57'D
Ballroom A & B	12,050	1536	720	900	20'	117'W x 96'D
Ballroom B & C	12,050	1536	720	900	20'	117'W x 96'D
Total	17,900	2304	1080	1280	20'	175'W x 96'D
Boardroom A	950				12'6"	
Boardroom B	650				10'6"	
Prefunction	13,250					

Utility Floor Boxes:

- Boxes on 30' centers
- Equipped with telephone service, multi-mode fiber & CAT6 data
- Power:
(1) 120v 20a dedicated + (1) 208/120v 3 phase 30a 5 wire

Rigging:

- 1,000 lbs. per rig point on a 15' x 15' grid

Ballroom Floors Live Load:

- 150 lbs./sq. ft.

Freight Elevator Size:

- **Elevator 04-1 & 14-1**
Dimension:
10'W x 11'8"D x 10'H
Weight Load:
6,000 lbs.
- **Elevator 14-2**
Dimension:
10'W x 19'8"D x 9'8"H
Weight Load:
12,000 lbs.

Level 2: Meeting Rooms



Meeting Rooms	Total Sq. Ft.	Theater	Classroom 18" X 96" Tables	Banquet 66" Rounds	Ceiling Height Footage	Dimensions
201 A	1600	182	108	140	16'	28'W x 52'D
201 B	1650	182	108	140	16'	29'W x 52'D
201 A-B	3250	396	180	250	16'	57'W x 52'D
202 A	1650	182	108	140	16'	29'W x 52'D
202 B	1650	182	108	140	16'	30'W x 52'D
202 C	1600	182	108	140	16'	29'W x 52'D
202 A-C	4900	582	252	400	16'	88'W x 52'D
203 A	650	60	27	40	16'	24'W x 25'D
203 B	700	72	36	40	16'	24'W x 27'D
203 A-B	1350	156	64	100	16'	24'W x 52'D
204	1650	182	108	120	16'	29'W x 52'D
205 A	1700	182	108	140	16'	29'W x 52'D
205 B	1700	182	108	140	16'	30'W x 52'D
205 C	1600	182	108	140	16'	29'W x 52'D
205 A-C	5000	582	252	400	16'	88'W x 52'D
206 A	700	84	36	40	16'	24'W x 26'D
206 B	650	77	27	40	16'	24'W x 25'D
206 A-B	1350	169	64	100	16'	24'W x 51'D
207 A	1650	182	108	140	16'	29'W x 51'D
207 B	1700	182	108	140	16'	30'W x 51'D
207 C	1700	182	108	140	16'	30'W x 51'D
207 D	1600	182	108	140	16'	29'W x 51'D
207 A-D	6650	829	344	440	16'	118'W x 51'D
208 A	1550	182	108	100	16'	28'W x 52'D
208 B	1650	240	108	140	16'	29'W x 52'D
208 A-B	3200	430	180	250	16'	57'W x 52'D
209 A	1650	182	108	140	16'	29'W x 52'D
209 B	1650	182	108	140	16'	30'W x 52'D
209 C	1550	182	108	100	16'	29'W x 52'D
209 A-C	4850	582	252	400	16'	88'W x 52'D
210	1250	144	56	90	16'	46'W x 25'D
211	1100	110	48	60	16'	42'W x 23'D
212	1250	142	64	70	16'	43'W x 26'D
213	800	75	36	60	16'	29'W x 25'D
214	1600	189	72	100	16'	57'W x 28'D
Total	38,200	4568	1972	2840		
Prefunction	29,350					
Registration	3000					

Level 2: Meeting Rooms



Level 3: Exhibit Hall



Level 3: Exhibit Hall

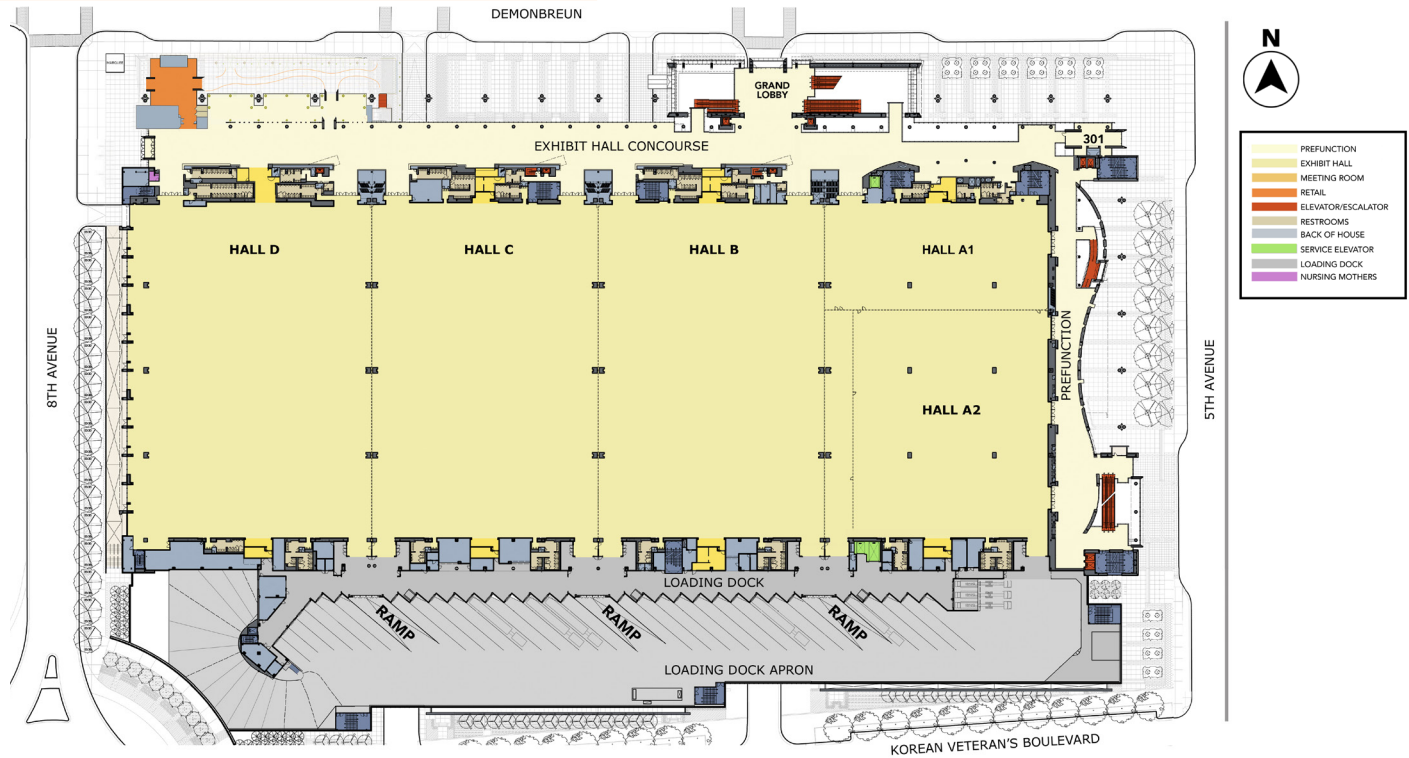

Exhibit Halls	Total Sq. Ft.	10'x10' Booths	Theater	Classroom 18" X 96" Tables	Banquet 66" Rounds	Ceiling Height Footage	Dimensions
A1	27,500	137	2668	1220	1350	32'6"	236'W x 113'D
A2	50,900	254	4308	2028	2540	32'6"	206'W x 241'D
A1-A2	86,143	391	8722	3940	4630	32'6"	240'W x 354'D
B	87,000	435	8696	3900	4800	32'6"	240'W x 354'D
C	87,000	435	8696	3900	4800	32'6"	240'W x 354'D
D	93,000	465	8696	4164	5010	32'6"	252'W x 350'D
Total Hall	353,143	1,726	34,205	16,920	20,170	32'6"	998'W x 354'D
301	1400					18'	
Food Lounge	2800					17'6"	
Prefunction	61,543						
Terrace	9,200						

Utility Floor Boxes:

- 352 floor boxes on 30' centers
- 32,000 lbs. on a 1" x 16" footprint
- Dimensions: 28"D x 19"W
- Equipped with telephone service, multi-mode fiber, CAT6, mic jacks, water + drainage, & compressed air 208/120v 3 phase 100a 5 wirepin &+ sleeve, (2) 30a, & (1) 20a
- 6a ballout to provide other services, i.e. 480v power

Docks:

- 32 total docks
- Weight Capacity: 320 lbs./sq. ft.
- Dock Leveler Capacity: 60,000 lbs.
- Dock Door Size: 8'W x 8'H
- 3 drive-in ramps

Hall Floors:

- Hall A: 6 columns 90' on center
- Hall B-D: 6 columns east to west, 240' on center, north to south 90' center
- Floor: 350 lbs./sq. ft.
- Pre-scored 10' x 10' exhibit floor

Roll-Up Door:

- Hall D: Northwest corner: Elephant Door: 22'6"W x 32'6"H
- Freight Doors: 16'W x 16'H

Rigging:

- 6,000 lbs. per rig point on 30' center can be loaded concurrently

Lighting:

- LED (dimmable) and 315W Metal Halide High bay on 30' center

29 Natural Gas connections

Level 3M: Show Managers

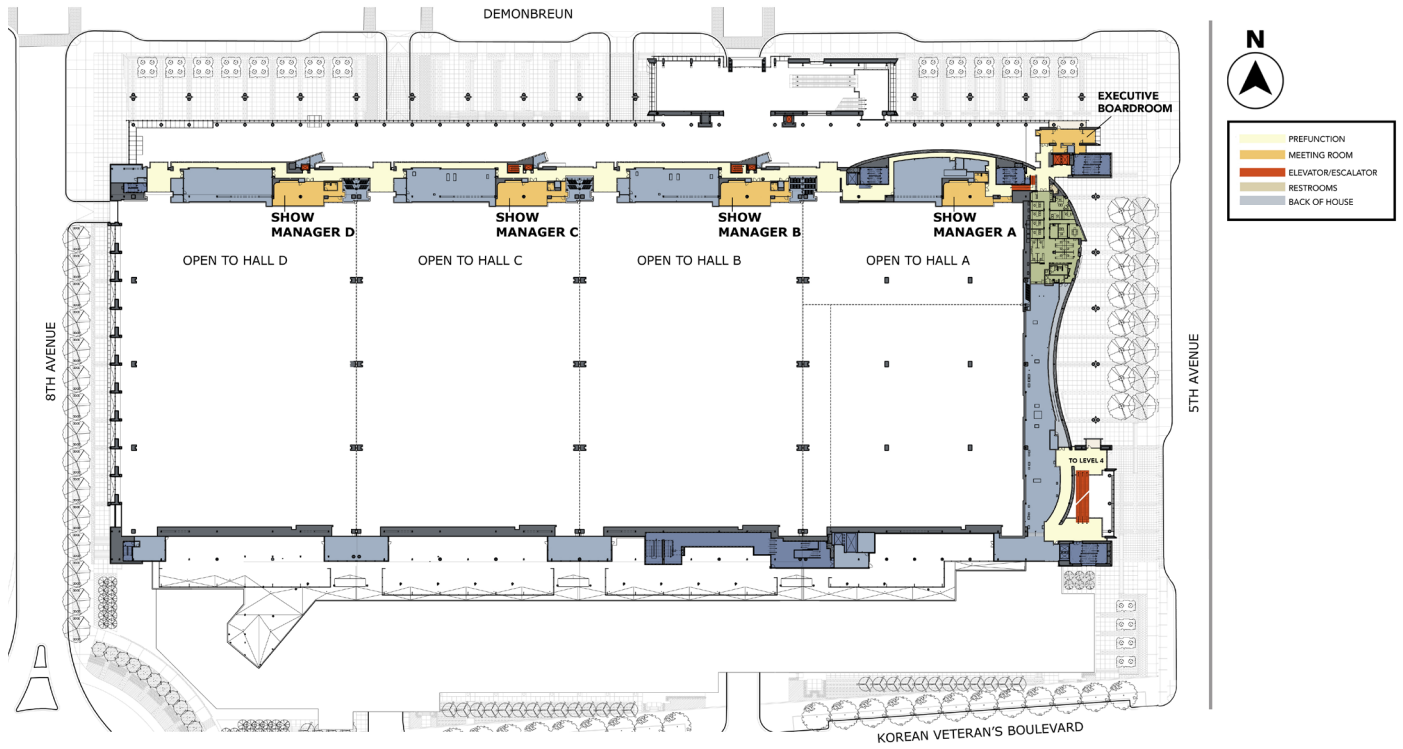

Show Offices	Total Sq. Ft.	Theater	Classroom 18" X 96" Tables	Banquet 66" Rounds	Ceiling Height Footage	Dimensions
Show Mrg A	1450	NA	NA	NA	10'	46'-54'W x 24'D
Show Mrg B	1700	NA	NA	NA	10'	54'W x 24'D
Show Mrg C	1700	NA	NA	NA	10'	54'W x 24'D
Show Mrg D	1800	NA	NA	NA	10'	54'W x 24'D
Boardroom	1100			12	12'6"	

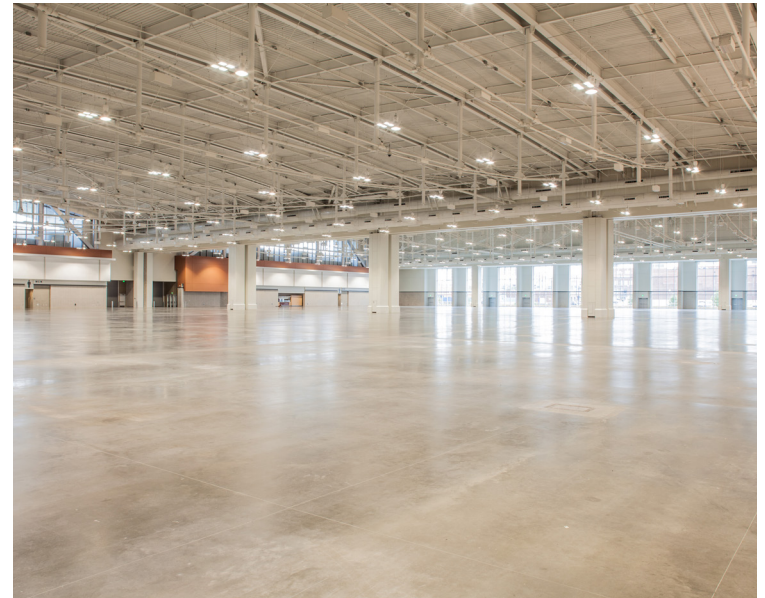

Level 4: Karl F. Dean Grand Ballroom

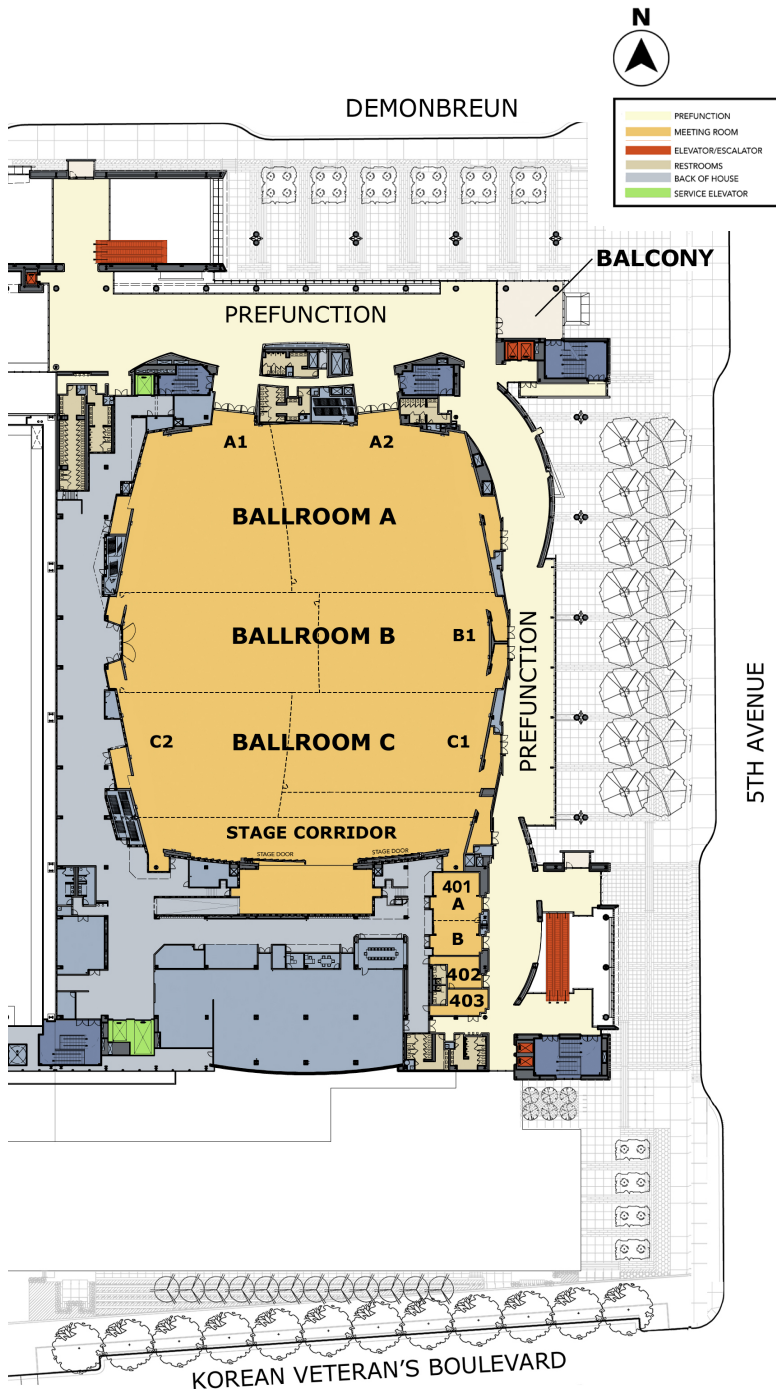

Ballrooms	Total Sq. Ft.	Theater	Classroom 18' X 96" Tables	Banquet 66" Rounds	Ceiling Height Footage	Dimensions
Ballroom A	21,600	2773	1352	1420	30'-40'	220'W x 160'D
A1	8350	1120	472	570	30'-40'	105'W x 100'D
A2	11,100	1400	588	690	30'-40'	100'W x 118'D
Ballroom B	13,900	2016	848	950	30'-40'	60'W x 215'D
B1	5900	914	376	400	30'-40'	60'W x 99'D
Ballroom C	16,850	2310	1108	1290	30'-40'	75'W x 211'D
C1	6750	940	444	480	30'-40'	60'W x 116'D
C2	6700	940	444	480	30'-40'	60'W x 100'D
Ballroom A & B	35,500	4700	2104	2350	30'-40'	220'W x 160'D
Ballroom B & C	30,750	4223	2028	2140	30'-40'	135'W x 215'D
Total	57,500	7453	3368	4030	30'-40'	220'W x 254'D
401 A	700	70	36	40	16'	
401 B	500	50	24	40	16'	
401 A-B	1200	140	60	80	16'	
402	400		Green Room		16'	
403	400		Green Room		16'	
Prefunction	22,400					
Balcony	1300					
Stage	5150				30'-40'	195'W x 28'D
Stage Corridor	5150				30'-40'	195'W x 28'D
Stage Opening					58'	

Utility Floor Boxes:

- Boxes on 30' centers
- Equipped with telephone service, multi-mode fiber & CAT6 data
- Power:
(1) 120v 20a dedicated + (1) 208/120v 3 phase 30a 5 wire

Freight Elevator Size:

- **Elevator 04-1 & 14-1**
Dimension: 7'8"W x 11'8"D x 10'H
Weight Load: 6,000 lbs.
- **Elevator 14-2**
Dimension: 10'W x 19'8"D x 9'8"H
Weight Load: 12,000 lbs.

Ballroom Floors Live Load:

- 150 lbs./sq. ft.

Rigging:

- 1,000 lbs. or 2,500 lbs. per rig point depends on location

Level 4: Karl F. Dean Grand Ballroom

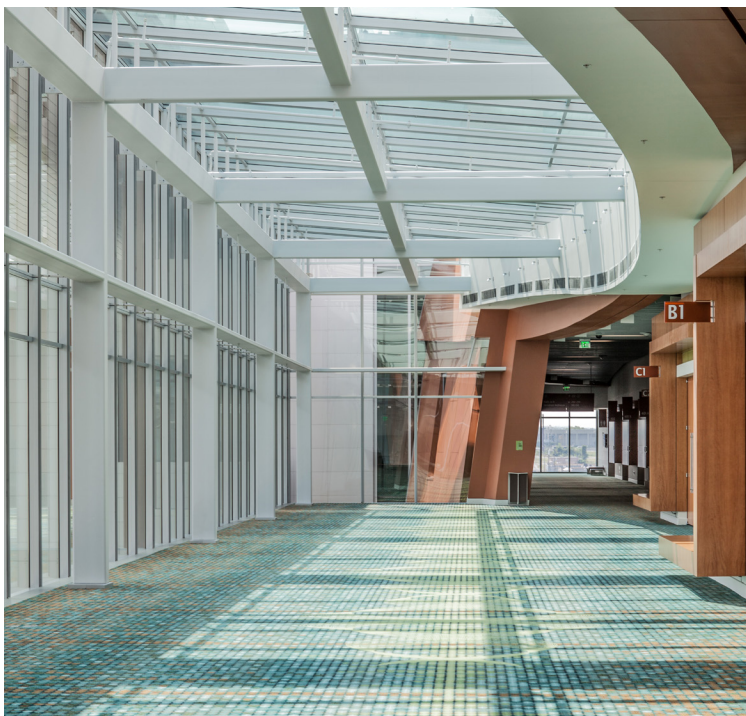
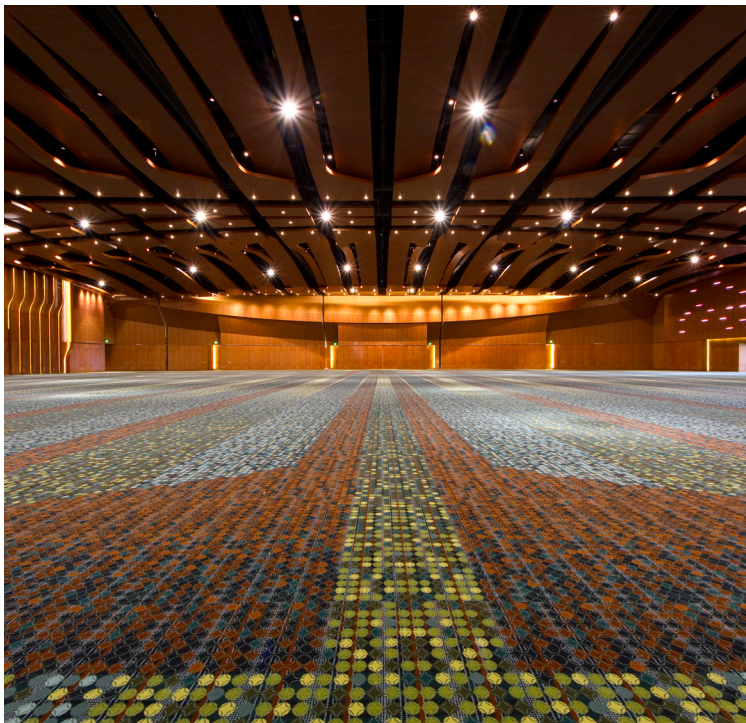

Food & Beverage

The Music City Center strives to create an authentic dining experience through its ongoing commitment to using regionally and locally sourced products and recipes. Our chef and his talented team allow clients to customize menus based on their dietary needs. We are committed providing every guest a memorable dining experience through our fresh, culinary creations.

Our kitchen prioritizes sustainability by minimizing environmental impact through its composting and recycling initiatives. Food waste is composted rather than being wasted in a landfill. Through MCC's food donation program, we help the vulnerable in our community by providing leftover meals to the Nashville Rescue Mission.

Our catering team offers social meals, receptions, exhibitor/booth catering and retail cart concessions. For more information, please contact **Catering Sales** at 615-401-1360.



Music City Center, a LEED Gold certified building, prioritizes sustainability in its day-to-day operations, engaging with our team, partners, community and clients. Our robust sustainability program includes rainwater collection, recycling, strategic partnership and energy conservation initiatives.

The building features a four-acre green roof which collects rainwater into a 360,000-gallon cistern. The water is utilized within toilets, urinals and irrigates outdoor landscaping, reducing our need for city-supplied water.

The roof also has 845 solar panels and is home to four beehives, which provide honey to the kitchen last year.

We strive to be a strong community partner through donations and outreach programs. We donate leftover items and food to local non-profit partners, including the Nashville Rescue Mission. Additionally, we utilize digital signage, which is available to events for marketing, to minimize environmental impact.

We support small, minority and women owned businesses through our Diversity Business Enterprise program. This includes seminars throughout the year, which offer procurement tips as well as information on doing business with MCC.



Are you interested in advancing sustainability throughout your event? If so, consider becoming a Green Partner.

The Green Partner program is available to events who participate in recycling, food and item donations and utilization of Music City Center's digital signage.

Recognition is received on MCC's sustainability wall during the event where the company logo is displayed as being a Green Partner as well as promotion on social media and marketing materials.

The program is managed by our in-house sustainability coordinator who can be reached at (615) 401-1420. Please visit www.nashvillemusiccitycenter.com/about/sustainability for more information.



Recycling

Acceptable Items

- Paper
- Cardboard
- Aluminum
- Tin
- Plastic #1-7

Unacceptable Items

- Glass
- Foam Core
- Styrofoam
- Garbage Bags
- Wood
- Metal
- Rock
- Brick



Item Donations

Acceptable Items

- Tote Bags/ Backpacks
- Giveaways
- School/Office Supplies
- Clothing
- Unused Water Bottles
- Furniture
- Home Goods
- Art/Craft Supplies

Unacceptable Items

- Electronics
- Signage



Food (REAL Certified)

Donations

- Non-Perishable
- Items
- Left Over Meals

Composting

- Kitchen Waste
- Left Over Food
- Disposableware



Digital Signage

Minimize environmental impact and go digital!

Digital Signage Packages

- Corner Wraps
- Video Walls
- Marquees
- Wayfinding Pods
- Room Board Screens

